

SUGAR BEET CYST PLOT
 HANKS
 SOUTH DAVIS

PLOT #

- 1. ANGELIA (PIGCELIA)
- 2. NEMEX (RADISH)
- 3. MAXI (MUSTARD)
- 4. PREGO (BUCKWHEAT)
- 5. FALLOW CHECK.

NOTES:

PLANTED: 8-20-91

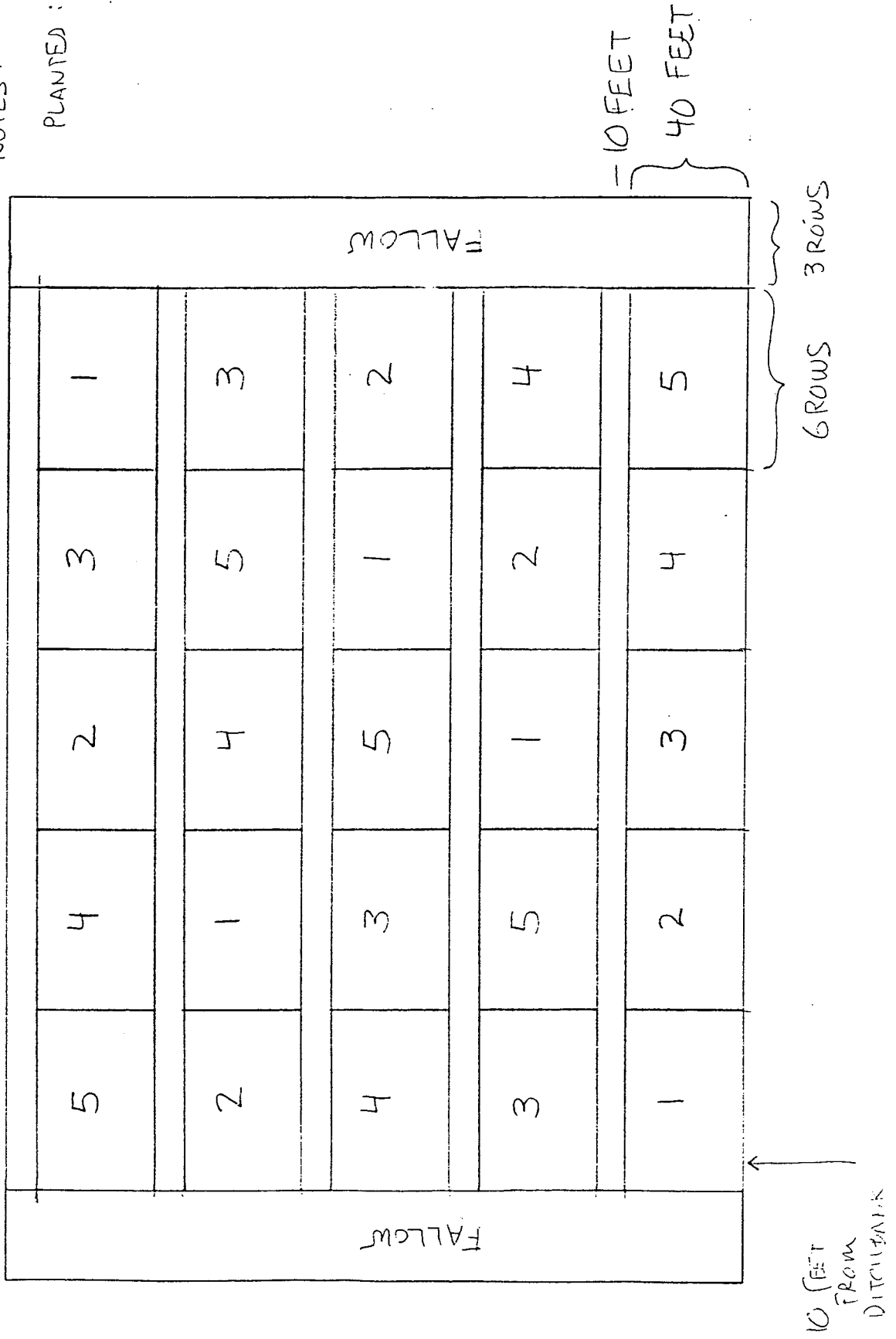

10 FEET FROM DITCH BANK

1989-90 EASTER LILY RESEARCH FOUNDATION/UC COOPERATIVE EXTENSION NEMATODE PLOT

- | | |
|--|---|
| 1. Check | 9. Vapam Drip Preplant + Vydate Drip Postplant |
| 2. Check | 10. Vapam Drip Preplant + Subdue Drip Postplant |
| 3. 1,3-D Injection | 11. Vapam Drip Preplant + Subdue & Vydate Drip Postplant |
| 4. 1,3-D Injection + Rampart | 12. GY-81 Drip Preplant |
| 5. 1,3-D Injection + Rampart + Subdue Drip | 13. GY-81 Drip Preplant + Subdue & Vydate Drip Postplant |
| 6. 1,3-D Injection + Rampart + Vydate Drip | 14. 1,3-D SL Drip Preplant |
| 7. Vapam Drip | 15. 1,3-D SL Drip Preplant + Subdue & Vydate Drip Postplant |
| 8. 1,3-D Injection + Subdue & Vydate Drip | |

OFFICE									
Rep A					Rep B				
12	6	15	8	4	10	3	2	6	13
14	9	3	1	10	14	9	12	15	7
2	11	7	5	13	8	4	5	1	11
13	4	15	6	7	3	11	6	14	1
10	14	2	9	3	7	13	2	10	8
1	11	5	8	12	12	4	9	5	15
Rep C					Rep D				

OCEAN

Actual amount of products used on a per acre basis: 1,3-D injection = 40 gpa broadcast
 Rampart = 80 lbs of 10G/acre; Vapam 800 ppm for 2.5 hours = 87 gpa;
 GY-81 (13% ai) 1,000 ppm for 2.5 hours = 280 gpa (36.4 lb carbon bisulfide);
 1,3-D SL (65% ai) 300 ppm for 2.5 hours = 17 gpa (11 gpa 1,3-D);
 Vydate L 100 ppm for 1.5 hours = 4.5 gpa (9 lbs ai);
 Subdue 100 ppm for 1.5 hours = 4.5 gpa (9 lbs ai).

GY-81 / Bacterial Canker Plot

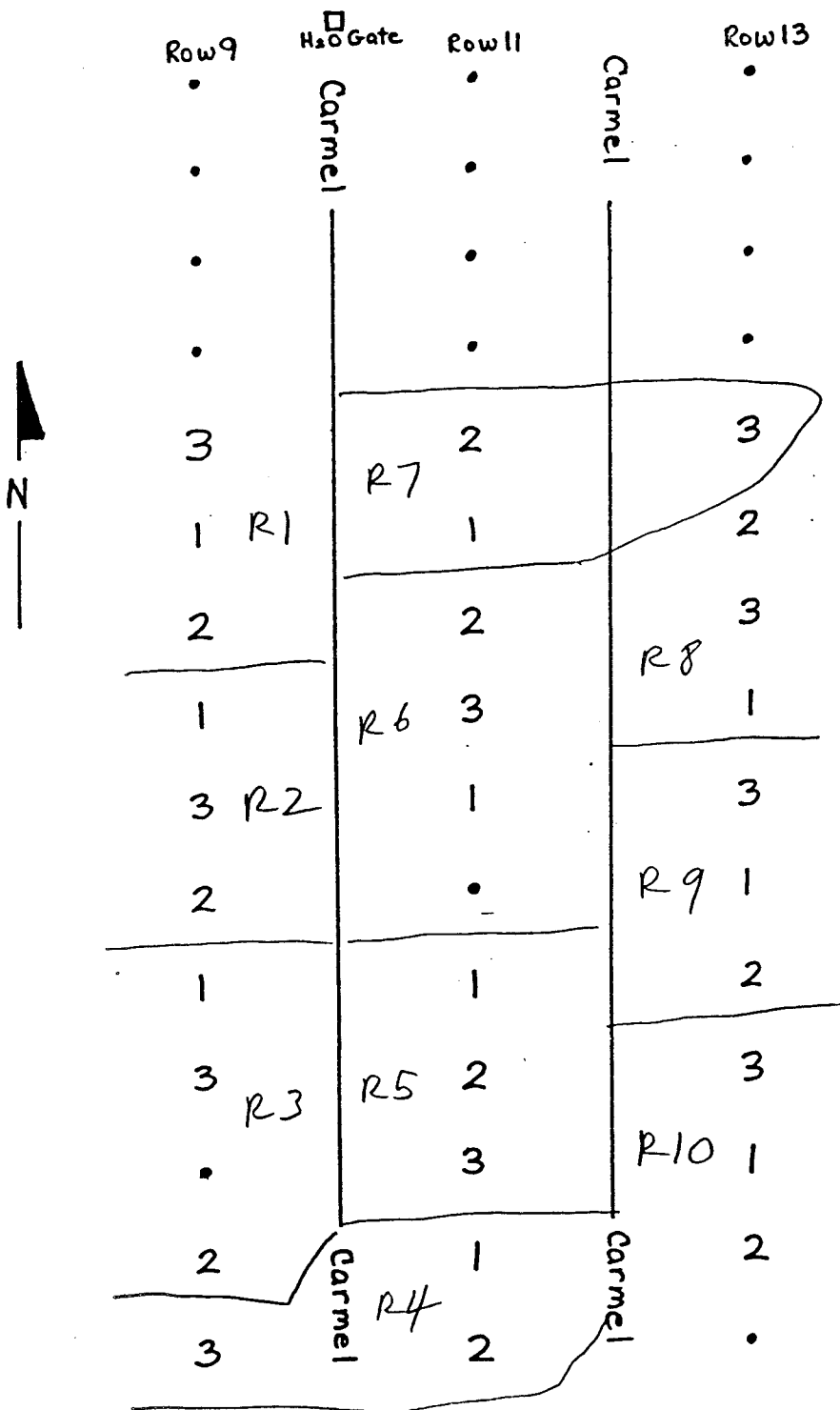

Treatments:

- T 1 (White) Untreated Check
- T 2 (Blue) Low Rate GY-81
- T 3 (Orange) Hi Rate GY-81

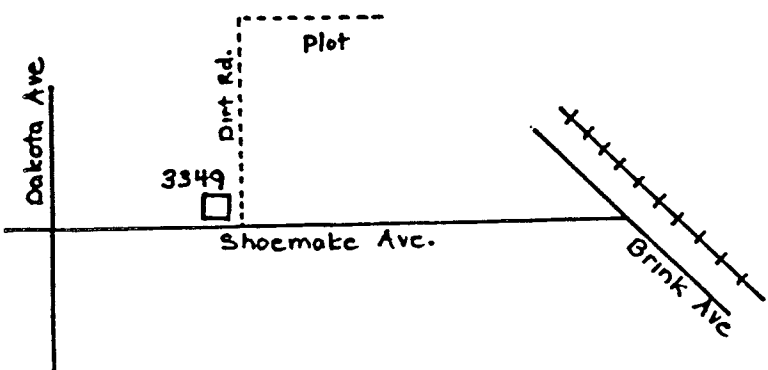

Grower: Owen Heinrich
Dwayne Heinrich

TEHAMA COUNTY PRUNE TRIAL - PACIFIC FARMS - DRIP IRRIGATED ORCHARD - FIELD 56
 FRENCH PRUNE ON 29C - PLANTED 1984 - TREE SPACING: 20' X 20' - 109 TREES/ACRE

- A GY-81 (ORANGE FLAGS); B NEMACUR 3 (BLUE FLAGS);
- C TELONE SL (GREEN FLAGS); D UNTREATED (WHITE FLAGS)

NORTH
 ↓

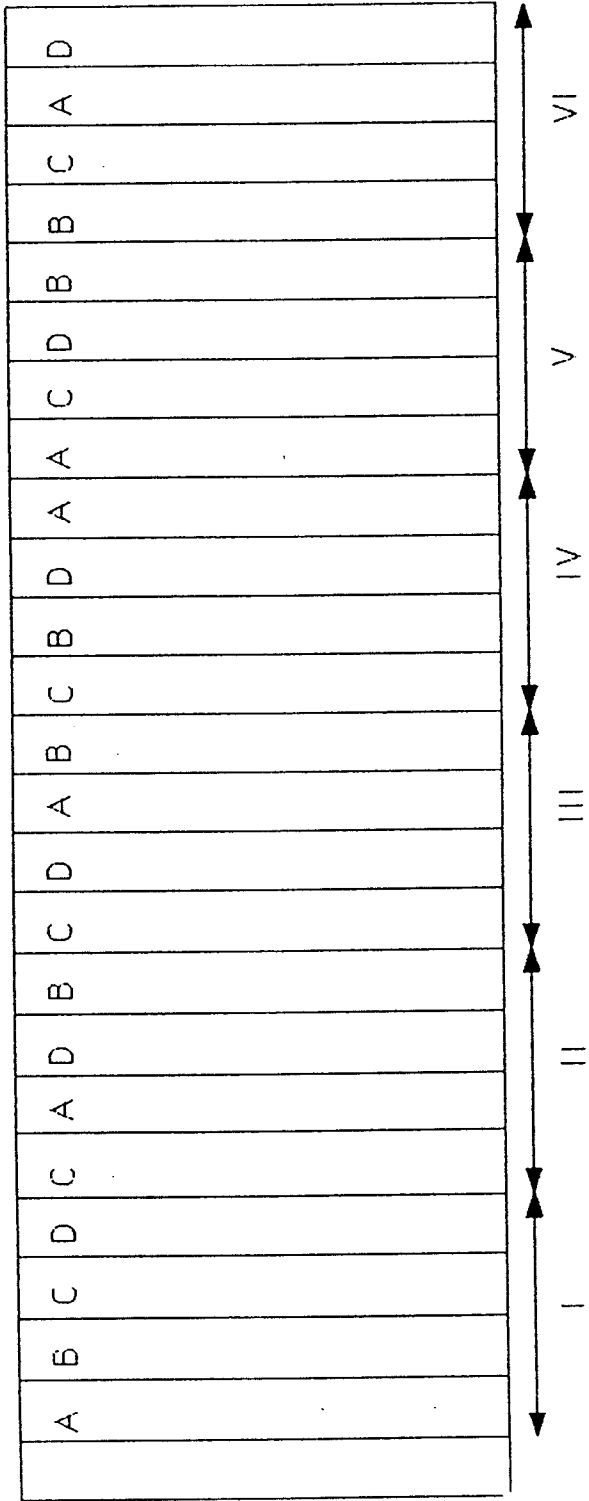

REPLICATE NUMBER

EMITTER SPACING: 41.2" (DELIVERING 0.75 GALLONS/HOUR). PLOT SIZE: 1 ROW WIDE X 8 TREES LONG.
 TREATMENT DATES AND RATES: MAY 8, 1989 - GY-81 (750 PPM CS₂ FOR 8 HOURS);
 NEMACUR 3 (1 GAL/TREATED ACRE, OR 340 ML IN 3 HOURS); TELONE SL (50 PPM FOR 3 HOURS,
 OR 153 ML IN 3 HOURS).

9/30/91

SAMPLE #5 for subsample WB

GY-81 - DRENCH TRIAL ON PRUNES - PACIFIC FARMS - TEHAMA COUNTY

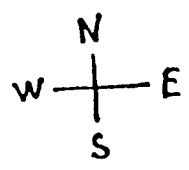

TREATMENT	TRT NO.	RATE	FLAG COLOR
GY-81	1	500 PPM CS2 IN 250 GALLONS OF WATER/TREE	RED
CHECK	2	1 GALLON OF 0-0-10 IN 250 GALLONS OF WATER/TREE	GREEN/BLUE

REP 6	GY 6	GY 12	GY 18	CK 24	CK 30	CK 36	GY 42	CK 48	GY 54
REP 5	CK 5	CK 11	CK 17	GY 23	GY 29	GY 35	CK 41	GY 47	CK 53
REP 4	GY 4	GY 10	GY 16	CK 22	CK 28	CK 34	CK 40	GY 46	CK 52
REP 3	CK 3	CK 9	CK 15	GY 21	GY 27	GY 33	GY 39	CK 45	GY 51
REP 2	CK 2	CK 8	CK 14	GY 20	GY 26	GY 32	GY 38	CK 44	GY 50
REP 1	GY 1	GY 7	GY 13	CK 19	CK 25	CK 31	CK 37	GY 43	CK 49
							A	B	C

15M	8D	8B	7B	9B	2B	1B	4C	CHECK 8C
14M	13M	16M	3A	5B	4B	3B	6A	9A 3 APPLICATIONS
12M	4A	5D	2C	6D	1A	5A	2A	9D 2 APPLICATIONS
6B	7A	1D	3D	6C	3C	5C	1C	8A 1 APPLICATION

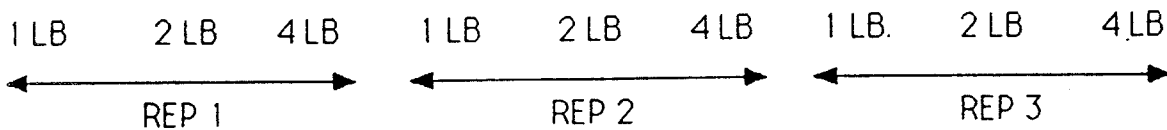

FOLIAR APPLIED VYDATE L - MCKINLEYVILLE - FORTUNE DAFFODIL

PLOT SIZE: 3 FEET X 10 FEET

Anderson Drip

NEMATODES, LTD.
DOUGLAS C. ANDERSON
4656 E. DAKOTA, SUITE 102
FRESNO, CA 93726
(209) 456-1043

UNOCAL GY-81 TEST PLOT

GROWER: DOUGLAS C. ANDERSON
LOCATION: 13709 S. ACADEMY
KINGSBURG, CA 93631

OFFICE=(209) 456-1043
PAGER=(209) 454-2529

454 VINES/ACRE (12 X 8 SPACING)
35 VINES/REP/TRT
175 VINES/REP/ALL TREATED
1050 VINES/TRIAL TREATED

N—>

1ST DIRT RD FROM ACADEMY

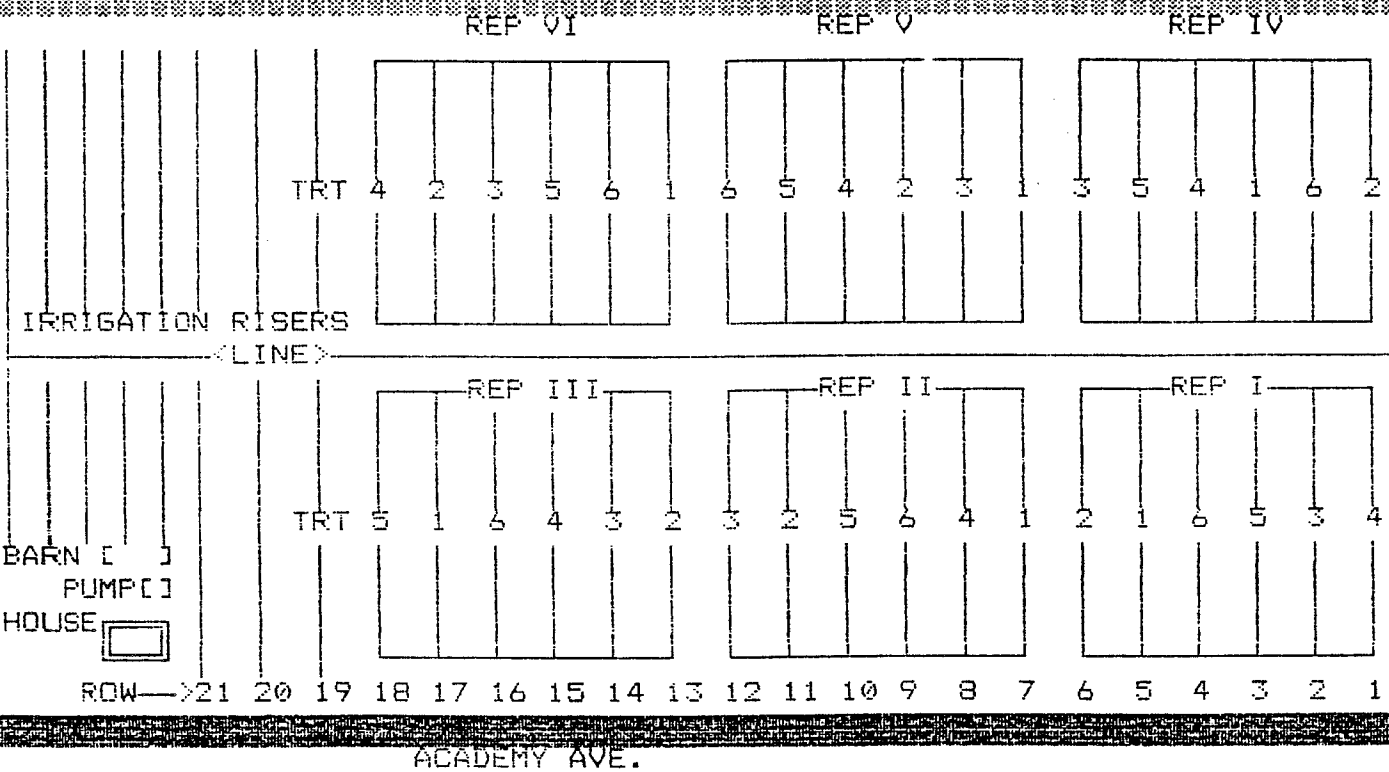

TRT	PPM	FORMULATED	LENGTH OF APP. HRS.
1	300	6.25 GPA	6
2	300	12.50 GPA	12
3	600	12.50 GPA	6
4	600	25.00 GPA	12
5	900	18.75 GPA	6
6	UTC		

UNOCAL CHEMICALS DIVISION
FIELD RESEARCH & DEVELOPMENT GROUP
RESIDUE & EFFICACY TREATMENT FORM

TRIAL NUMBER: 89/91-213-CS GROWER: Doug Anderson UNOCAL REP. OR CONTRACT RESEARCHER: Nerd
 /EUP NUMBER: EUP FIELD NAME: K-10 DEALER: _____

TRIAL DATA

PURPOSE OF TRIAL: <u>Efficacy</u>	TARGET PEST/PROBLEM: <u>Footrot, damping, vert</u>
HARVEST DATE: <u>8/15/91</u>	ACRES TREATED: <u>2.3</u>
ACRES CONTROL: <u>0.46</u>	
LOCATION (ATTACH MAPS) CROSSROADS: _____	TOWN: <u>Kingsburg</u> COUNTY: <u>Fresno</u> STATE: <u>CA</u>
	T: <u>165</u> R: <u>72E</u> SEC: <u>3</u>

CROP DATA

CURRENT CROP: <u>Corn</u>	VARIETY: <u>Thompson Seed</u>	ROOT STOCK: <u>Own</u>	PLANTING DATE: <u>1/19/91</u>
PREVIOUS CROP: _____	PLANT SPACING: <u>8' x 12'</u>	PLANT DENSITY (#/A): <u>454</u>	SOIL TEXTURE: <u>Sandy loam</u>

IRRIGATION DATA

SYSTEM TYPE: <u>Drip</u>	FREQUENCY: <u>daily</u>	AMOUNT EACH TIME: <u>4-6 hrs</u>	FLOW RATE: _____
IF LOW VOLUME IRRIGATION: _____	EMITTER FLOW RATE: <u>0.6 gph</u>	EMITTERS/PLANT: <u>2</u>	TOTAL FLOW RATE: _____

TREATMENT DATA

CODE	TREATMENT A.I.	FORMULATION	LOT / SER. #	FORMULATED RATE/ACRE A.I.	NO. OF REPS.	NO. OF APPS.	LENGTH OF APP. (HRS)
A	722 PPM	31.8%	Bulk - Pioneer	6.25 gpa	6	2	6
B	722 PPM	"	Stockton	12.5 "	↓		12
C	1445 PPM	"		12.5 "			6
D	1445 PPM	"		25.0 "			12
E	2168 PPM	"		18.75 "			6
F							12

WATER APPLICATION DATA

TREATMENT CODE:	A	B	C	D	E
APPLICATION DATE(S):	<u>5/6/91</u>	<u>5/23/91</u>			
APPLICATION METHOD:	<u>Drip Irrigation</u>	<u>Injection</u>			
SPRAYER TYPE:					
SPEED:					
PRESSURE/VOLUME:	<u>1</u>	<u>1</u>	<u>1</u>	<u>1</u>	<u>1</u>
NOZZLE TYPE:					
SIZE / HEIGHT:	<u>1</u>	<u>1</u>	<u>1</u>	<u>1</u>	<u>1</u>
SPACING:					
SIAMIC TYPE:					
DEPTH/SPACING:	<u>1</u>	<u>1</u>	<u>1</u>	<u>1</u>	<u>1</u>
NO. OF SIAMICS:					
APPLIED (A,T,S):					
AMOUNT USED:	<u>36 gal</u>	<u>36 gal</u>			
RESIDUE (Y/N):	<u>No</u>	<u>No</u>			

CONDITIONS AT EACH APPLICATION

APPLICATION DATE:	<u>5/6/91 9:30 PM</u>	<u>5/23/91</u>		
TIME IRRIG. ON / OFF:	<u>7:30 AM / 4:30 PM</u>	<u>→</u>	<u>1</u>	<u>1</u>
TIME TX BEGINS / ENDS:	<u>9:30 AM / 3:30 PM</u>	<u>→</u>	<u>1</u>	<u>1</u>
CROP GROWTH STAGE:	<u>Post-Blatt</u>	<u>→</u>		
AIR TEMP. / REL. HUM.:	<u>79°F / 35%</u>	<u>77°F / 40%</u>	<u>1</u>	<u>1</u>
SOIL TEMP: 6" / 12" F	<u>70 / 68</u>	<u>71 / 69</u>	<u>1</u>	<u>1</u>
pH: PRE / POST	<u>6.8 / 6.8</u>	<u>6.8 / 6.8</u>	<u>1</u>	<u>1</u>
MOISTURE (H,M,L):	<u>High</u>	<u>High</u>		
WATER TEMP:	<u>68°F</u>	<u>67°F</u>		
pH: PRE / POST	<u>8.3 / 8.3</u>	<u>8.3 / 8.3</u>	<u>1</u>	<u>1</u>
IRRIGATION (HRS):	<u>7</u>	<u>7</u>	<u>1</u>	<u>0.17</u>

UNOCAL

Chemicals & Minerals Division Agricultural Products Group

Application Information

Code	Application Date:	10/18/91	5/6/92	
TET #1	Treatment Substance	GY-81	ENZONÉ	
	Rate / Acre Formulated	6.25 gal	6.25 GPA	
	Concentration (ppm a.i.)	300 ppm CS ₂	300 ppm CS ₂	
	Lot and Serial Number	N/A / BULK	N/A BULK	
	Source or Dealer	PUREGRO - STOCKTON	PUREGRO - STOCKTON	
	Irrigation Flow Rate	9.6 gph / 4.8 GPM	4.80 GPM	
	Time Irrig. On / Off	7:30 AM / 4:30 PM ^{10/17/91}	10:00 AM / 4:00 PM	1
	Time App. Begins / Ends	9:30 AM / 3:50 PM	10:00 AM / 4:00 PM	1
	Gals. Used / Acreage	2.9 / 0.46	2.86 / 0.46	1
TET #2	Treatment Substance	GY-81	ENZONÉ	
	Rate / Acre Formulated	12.5 gal	12.5	
	Concentration (ppm a.i.)	300 ppm CS ₂	300 ppm CS ₂	
	Lot and Serial Number	N/A / BULK	N/A - Bulk	
	Source or Dealer	PUREGRO - STOCKTON	PUREGRO - STOCKTON	
	Irrigation Flow Rate	9.6 gph / 4.8 GPM	4.8 gpm	
	Time Irrig. On / Off	7:30 AM / 4:30 PM ^{10/17/91}	10:00 AM / 10:00 AM	1
	Time App. Begins / Ends	9:30 AM / 9:50 PM	10:00 AM / 10:00 PM	1
	Gals. Used / Acreage	5.9 / 0.46	5.8 / 0.46	1
TET #3	Treatment Substance	GY-81	ENZONÉ	
	Rate / Acre Formulated	12.5 gal	12.5 gal	
	Concentration (ppm a.i.)	600 ppm CS ₂	600 ppm CS ₂	
	Lot and Serial Number	N/A / BULK	N/A BULK	
	Source or Dealer	PUREGRO - STOCKTON	PUREGRO - STOCKTON	
	Irrigation Flow Rate	4.8 gph	4.8 GPM	
	Time Irrig. On / Off	9:30 PM / 4:50 PM ^{10/17/91}	10:00 PM / 4:00 AM	1
	Time App. Begins / Ends	9:30 PM / 3:50 AM ^{10/17/91}	10:00 PM / 4:00 AM	1
	Gals. Used / Acreage	5.7 / 0.46	5.8 / 0.46	1

Name _____

Location _____

PLOT Numb. of Trts _____ Design _____ Reps _____ Rows/Plot _____
Plot Size _____ Length Feet _____ Meters _____ Width Feet _____ Meters _____
Preplant Treatment Dates _____ Atplanting/Postplant Dates _____

NEMATODE Common _____ Scientific Name _____
Sample Method _____
Extraction Method _____ Reference _____

CROP Common Name _____ Scientific Name _____
Planting Date _____ Stage of Growth _____ Harvest Date _____
Spacing _____ Density _____ Rootstock _____ Planting Material _____
Phytotoxicity _____
Harvest Method _____

WEATHER CIMIS Station _____ Wind _____ Clouds _____ First Rain _____
Soil Faren _____ FtoC _____ Cent _____ CtoF _____ Air Faren _____ FtoC _____ Cent _____ CtoF _____

SOIL Type _____ Sand _____ Silt _____ Clay _____ Organic _____ pH _____ CEC _____

CULTURAL PRACTICES Previous Crop _____
Tillage _____
Herbicide _____
Fertilizer _____
Pest Control _____

IRRIGATION Type _____ Source _____
Frequency _____ Flow Rate _____
Amount _____ Spacing _____
On _____ Off _____ Preirrigation _____

DRIP Tubing _____
Pump _____
Manifold _____
Pressure _____ Preirrigation _____ Trt. Nums. _____ Date _____

SPRAYER Type _____ Nozzle Type _____
Number _____ Spacing _____ Pressure _____ Height _____ Speed _____
Volume _____ Carrier Type/Source _____ Trt. Nums. _____ Date _____

GRANULAR Equipment _____ Date _____
Calibration _____ Trt. Nums. _____

SHANK Type _____ Depth _____ Pressure _____ Trt. Nums. _____
Spacing _____ Number _____ Soil Moisture _____ Date _____

INCORPORATION Equipment _____
Depth _____ Date and Time _____ Treatments _____

Persons Present _____
Photos _____ Other Files _____

TRACTOR _____ Date _____
Gear _____ RPM _____ Distance _____ Time _____ Notes _____

PlotCode

Plot Name _____ Location _____

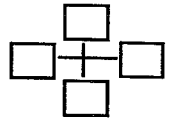

Number of
Trtments Reps

--	--	--	--	--	--	--	--

Replicate
Length Width

--	--	--	--	--	--	--	--

--	--	--	--	--	--	--	--

Rows/Plot

--	--	--	--	--	--	--	--

--	--	--	--	--	--	--	--

Application Date

--	--	--	--	--	--	--	--

--	--	--	--	--	--	--	--

Trt. Length (ft)

--	--	--	--	--	--	--	--

--	--	--	--	--	--	--	--

Row Width (inch)

--	--	--	--	--	--	--	--

--	--	--	--	--	--	--	--

Bnd Width (inch)

--	--	--	--	--	--	--	--

--	--	--	--	--	--	--	--

2nd Applic. Date

--	--	--	--	--	--	--	--

--	--	--	--	--	--	--	--

Trt. Length (ft)

--	--	--	--	--	--	--	--

--	--	--	--	--	--	--	--

Row Width (inch)

--	--	--	--	--	--	--	--

--	--	--	--	--	--	--	--

Bnd Width (inch)

--	--	--	--	--	--	--	--

--	--	--	--	--	--	--	--

--	--	--	--	--	--	--	--

--	--	--	--	--	--	--	--

--	--	--	--	--	--	--	--

--	--	--	--	--	--	--	--

--	--	--	--	--	--	--	--

--	--	--	--	--	--	--	--

--	--	--	--	--	--	--	--

--	--	--	--	--	--	--	--

--	--	--	--	--	--	--	--

--	--	--	--	--	--	--	--

--	--	--	--	--	--	--	--

--	--	--	--	--	--	--	--

--	--	--	--	--	--	--	--

--	--	--	--	--	--	--	--

--	--	--	--	--	--	--	--

--	--	--	--	--	--	--	--

--	--	--	--	--	--	--	--

--	--	--	--	--	--	--	--

--	--	--	--	--	--	--	--

--	--	--	--	--	--	--	--

--	--	--	--	--	--	--	--

--	--	--	--	--	--	--	--

--	--	--	--	--	--	--	--

--	--	--	--	--	--	--	--

--	--	--	--	--	--	--	--

--	--	--	--	--	--	--	--

--	--	--	--	--	--	--	--

--	--	--	--	--	--	--	--

--	--	--	--	--	--	--	--

--	--	--	--	--	--	--	--

--	--	--	--	--	--	--	--

--	--	--	--	--	--	--	--

--	--	--	--	--	--	--	--

--	--	--	--	--	--	--	--

--	--	--	--	--	--	--	--

--	--	--	--	--	--	--	--

--	--	--	--	--	--	--	--

--	--	--	--	--	--	--	--

--	--	--	--	--	--	--	--

--	--	--	--	--	--	--	--

--	--	--	--	--	--	--	--

--	--	--	--	--	--	--	--

--	--	--	--	--	--	--	--

--	--	--	--	--	--	--	--

--	--	--	--	--	--	--	--

--	--	--	--	--	--	--	--

--	--	--	--	--	--	--	--

--	--	--	--	--	--	--	--

--	--	--	--	--	--	--	--

--	--	--	--	--	--	--	--

--	--	--	--	--	--	--	--

--	--	--	--	--	--	--	--

--	--	--	--	--	--	--	--

--	--	--	--	--	--	--	--

--	--	--	--	--	--	--	--

--	--	--	--	--	--	--	--

--	--	--	--	--	--	--	--

--	--	--	--	--	--	--	--